

45 44 43 42 41 40 39 38 37 36 35 34 33 32 31 30 29 28 27 26 25 24 23 22 21 20 19 18 17 16 15 14 13 12 11 10 9 8 7 6 5 4 3 2 1 0 A B C

REVISIONS					REFERENCES		
NO.	DESCRIPTION	BY	APPVD	DATE	NO.	DWG NO.	TITLE
1	1. INCORPORATED 02 DECK ARRANGEMENT PER EXISTING T059 ARRANGEMENT. 2. REVISED 01 DECK & 02 DECK FORWARD BROW EDGE TO VERTICAL FLAT BAR	WHL	CD	11/03/10			
2	1. REVISED 02 DECK TO PREVIOUS T055 ARRANGEMENT, EXCEPT W/ STANDARD SQUARE HOT TUB 2. DELETED AFT MAIN DECK & 01 DECK WIND SCREENS 3. ADDED 4 UMBRELLA SOCKETS ON 02 DECK 4. DELETED CANOPY SOCKETS ON 02 FWD BULWARKS	WHL	PN	11/8/10			
3	1. REVISED LOCATION OF HOT TUB ON 02 DECK PER EXTERIOR FURNITURE DRAWING REV 0 2. OVERALL LENGTH ADJUSTED TO MATCH CONSTRUCTION DRAWINGS 3. REVISED STERN LIGHT FOUNDATION PER 01 DECK BULWARK DRAWING REV 0.	WHL	MJD	8/02/12			

**TRINITY YACHTS**  
 13085 SEAWAY ROAD  
 GULFPORT, MS 39503  
 228-276-1000  
 FAX 228-276-1002

This drawing, design concept, and specifications are the property of **TRINITY YACHTS, LLC.** and are furnished on a confidential basis with an expressed understanding that they will not be copied in any manner, used for manufacture, sold, transferred, nor used to the detriment of said firm without written permission. The recipient further agrees not to disclose these contents hereof to any other parties except for those specific purposes for which this drawing was issued.

APPROVALS  
 TY \_\_\_\_\_ CLASS \_\_\_\_\_  
 OWNER \_\_\_\_\_ FLAG \_\_\_\_\_

**PLEASANT CORPORATION**  
**164' TRI-DECK MOTOR YACHT**  
**PROFILE & OUTBOARD VIEWS**

SCALE: 3/16" = 1'-0"      DATE: 11/15/10

DRAWN BY: RJW      CK'D BY: JDIII  
 HULL NO.: 059      JOB NO.: T059

DWG NO. **10111-00**  
 SHT 1 OF 1  
 REV 3P

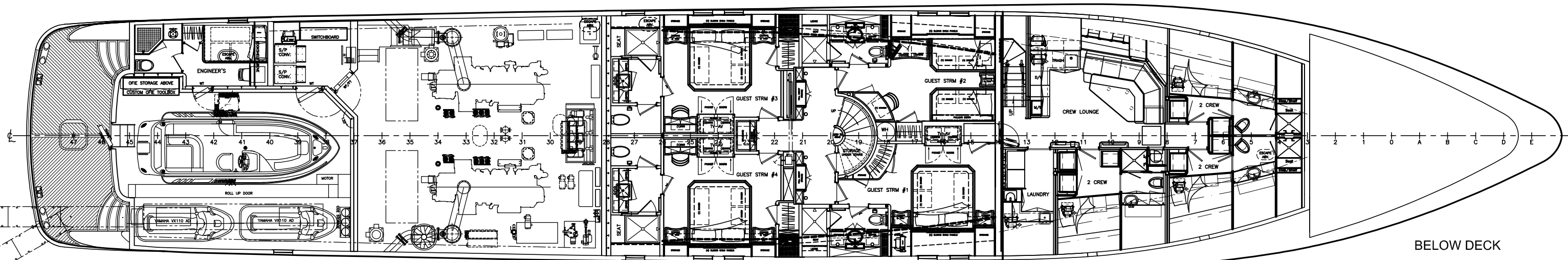
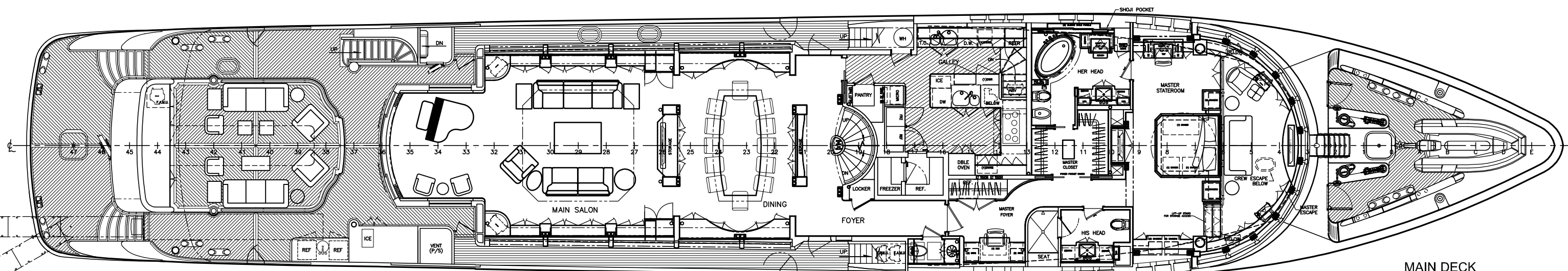
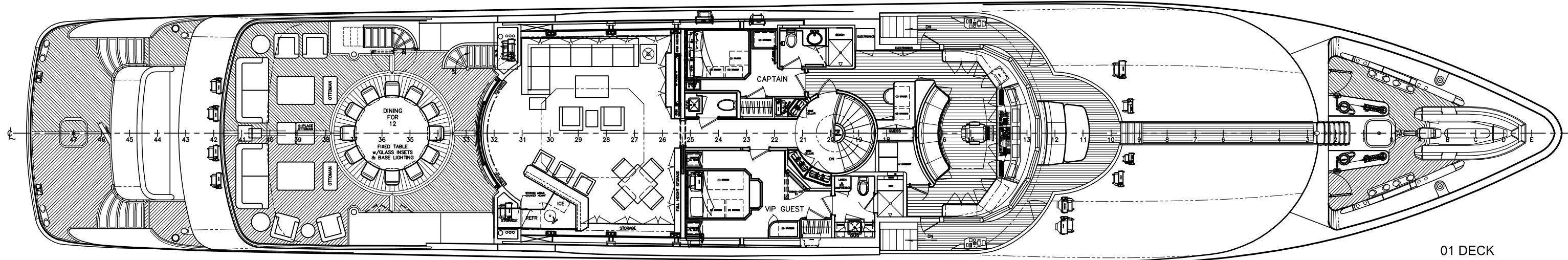

REVISIONS				
NO.	DESCRIPTION	BY	APPVD	DATE
1	1. REVISED GENERAL ARRANGEMENT TO MATCH T055 2. ADDED DAVIT SOCKETS TO FOREDECK, DELETED EXISTING DAVIT 3. ADDED TEAK ON FOREDECK	WHL	CD	11/03/10
2	1. DELETED B.E.R.P. BETWEEN ENGINE ROOM & GARAGE 2. ADDED CABINET IN OWNERS CLOSET 4. ADDED TEAK AFT RAISED MAINDECK PER PKD DRAWINGS 5. CHANGED P/S CABINETS IN MAIN SALOON FRAME 26	WHL	PN	11/8/10
3	REVISED DOOR SWING IN AFT GUEST HEADS, INTO HEADS	WHL	PN	11/8/10

**TRINITY YACHTS**  
 13085 SEAWAY ROAD  
 GULFPORT, MS 39503  
 228-276-1000  
 FAX 228-276-1002

This drawing, design concept, and specifications are the property of **TRINITY YACHTS, LLC.** and are furnished on a confidential basis with an expressed understanding that they will not be copied in any manner, used for manufacture, sold, transferred, nor used to the detriment of said firm without written permission. The recipient further agrees not to disclose these contents hereof to any other parties except for those specific purposes for which this drawing was issued.

APPROVALS  
 TY \_\_\_\_\_ CLASS \_\_\_\_\_  
 OWNER \_\_\_\_\_ FLAG \_\_\_\_\_

**PLEASANT CORPORATION**  
**164' TRI-DECK MOTOR YACHT**  
**GENERAL ARRANGEMENT**

SCALE: 3/16" = 1'-0"  
 DATE: 11/15/10  
 DWG NO. 10112-00  
 SHT 1 OF 1  
 REV 3P

DRAWN BY: RJW  
 CK'D BY: JDIII  
 HULL NO.: 059  
 JOB NO.: T059