

02 SUN DECK

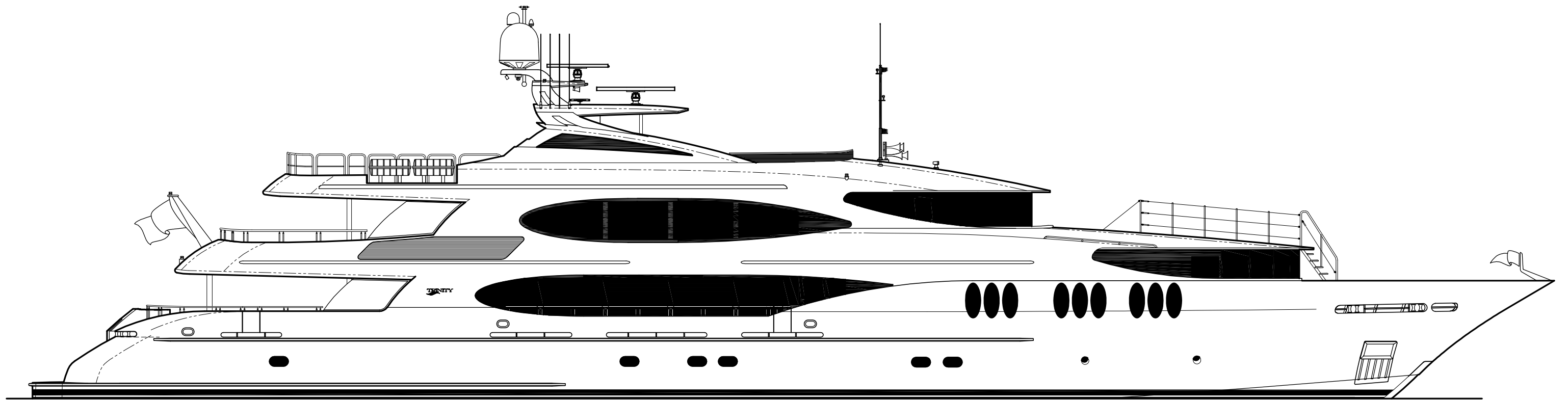

45 44 43 42 41 40 39 38 37 36 35 34 33 32 31 30 29 28 27 26 25 24 23 22 21 20 19 18 17 16 15 14 13 12 11 10 9 8 7 6 5 4 3 2 1 0 A B C

| REVISIONS | | | | |
|-----------|---------------------------------------------------------------------------------------------------------------------------------------------------------------------------------------------------------------------------------|-----|-------|----------|
| NO. | DESCRIPTION | BY | APPVD | DATE |
| 1 | 1. INCORPORATED 02 DECK ARRANGEMENT PER EXISTING T059 ARRANGEMENT. 2. REVISED 01 DECK & 02 DECK FORWARD BROW EDGE TO VERTICAL FLAT BAR | WHL | CD | 11/03/10 |
| 2 | 1. REVISED 02 DECK TO PREVIOUS T055 ARRANGEMENT, EXCEPT W/ STANDARD SQUARE HOT TUB 2. DELETED AFT MAIN DECK & 01 DECK WIND SCREENS 3. ADDED 4 UMBRELLA SOCKETS ON 02 DECK 4. DELETED CANOPY SOCKETS ON 02 FWD BULWARKS | WHL | PN | 11/8/10 |
| 3 | 1. REVISED LOCATION OF HOT TUB ON 02 DECK PER EXTERIOR FURNITURE DRAWING REV 0 2. OVERALL LENGTH ADJUSTED TO MATCH CONSTRUCTION DRAWINGS 3. REVISED STERN LIGHT FOUNDATION PER 01 DECK BULWARK DRAWING REV 0. | WHL | MJD | 8/02/12 |

| REFERENCES | | |
|------------|---------|-------|
| NO. | DWG NO. | TITLE |
| | | |
| | | |
| | | |

TRINITY YACHTS
 13085 SEAWAY ROAD
 GULFPORT, MS 39503
 228-276-1000
 FAX 228-276-1002

This drawing, design concept, and specifications are the property of **TRINITY YACHTS, LLC.** and are furnished on a confidential basis with an expressed understanding that they will not be copied in any manner, used for manufacture, sold, transferred, nor used to the detriment of said firm without written permission. The recipient further agrees not to disclose these contents hereof to any other parties except for those specific purposes for which this drawing was issued.

APPROVALS
 TY _____ CLASS _____
 OWNER _____ FLAG _____

PLEASANT CORPORATION
164' TRI-DECK MOTOR YACHT
PROFILE & OUTBOARD VIEWS

SCALE: 3/16" = 1'-0" DATE: 11/15/10

DRAWN BY: RJW CK'D BY: JDIII
 HULL NO.: 059 JOB NO.: T059

DWG NO. **10111-00**
 SHT 1 OF 1
 REV 3P

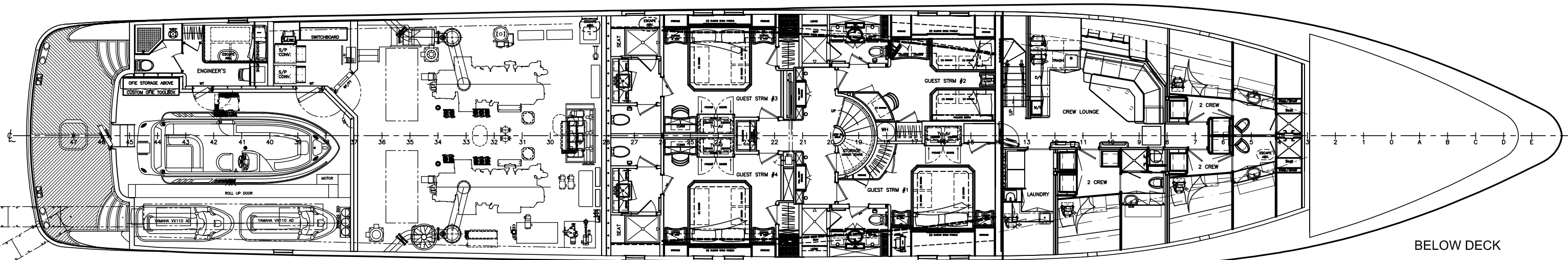
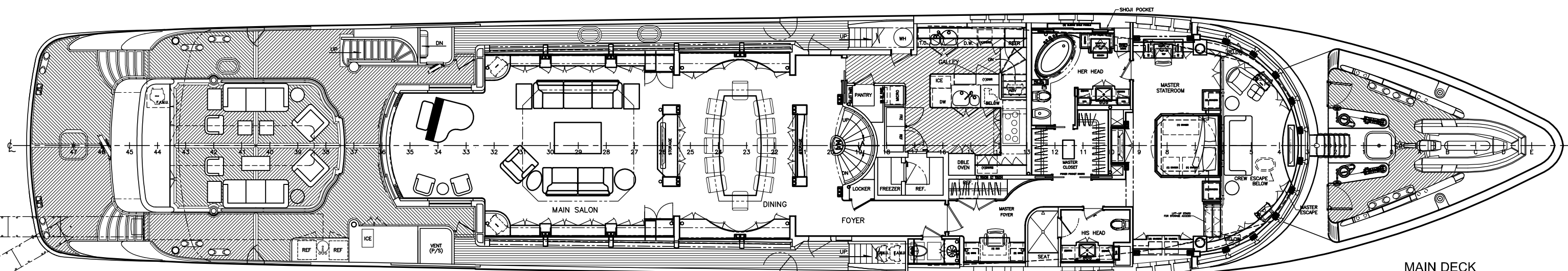
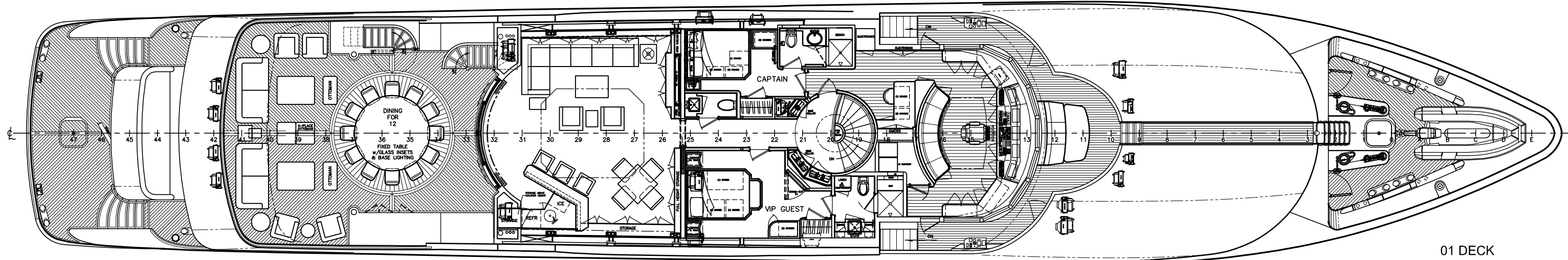

| REVISIONS | | | | |
|-----------|------------------------------------------------------------------------------------------------------------------------------------------------------------------------------------------------|-----|-------|----------|
| NO. | DESCRIPTION | BY | APPVD | DATE |
| 1 | 1. REVISED GENERAL ARRANGEMENT TO MATCH T055 2. ADDED DAVIT SOCKETS TO FOREDECK, DELETED EXISTING DAVIT 3. ADDED TEAK ON FOREDECK | WHL | CD | 11/03/10 |
| 2 | 1. DELETED B.E.R.P. BETWEEN ENGINE ROOM & GARAGE 2. ADDED CABINET IN OWNERS CLOSET 4. ADDED TEAK AFT RAISED MAINDECK PER PKD DRAWINGS 5. CHANGED P/S CABINETS IN MAIN SALOON FRAME 26 | WHL | PN | 11/8/10 |
| 3 | REVISED DOOR SWING IN AFT GUEST HEADS, INTO HEADS | WHL | PN | 11/8/10 |

TRINITY YACHTS
 13085 SEAWAY ROAD
 GULFPORT, MS 39503
 228-276-1000
 FAX 228-276-1002

This drawing, design concept, and specifications are the property of **TRINITY YACHTS, LLC.** and are furnished on a confidential basis with an expressed understanding that they will not be copied in any manner, used for manufacture, sold, transferred, nor used to the detriment of said firm without written permission. The recipient further agrees not to disclose these contents hereof to any other parties except for those specific purposes for which this drawing was issued.

APPROVALS
 TY _____ CLASS _____
 OWNER _____ FLAG _____

PLEASANT CORPORATION
164' TRI-DECK MOTOR YACHT
GENERAL ARRANGEMENT

SCALE: 3/16" = 1'-0"
 DATE: 11/15/10
 DWG NO. 10112-00
 SHT 1 OF 1
 REV 3P

DRAWN BY: RJW
 CK'D BY: JDIII
 HULL NO.: 059
 JOB NO.: T059