

EUPHORIA



168' (51.2 M) TRINITY MOTOR YACHT

LUXURY • CUSTOM • YACHTS

EUPHORIA



EUPHORIA

SPECIFICATIONS

LENGTH:	168' (51.2 M)
BEAM:	28' (8.5 M)
DRAFT:	7'10" (2.3 M)
YEAR COMPLETED:	TBD
BUILDER:	TRINITY
MODEL:	MOTOR YACHT
HULL CONFIGURATION:	SEMI-DISPLACEMENT
HULL CONSTRUCTION:	ALUMINUM
FLAG:	NOT DETERMINED
CLASSIFICATION:	AMERICAN BUREAU OF SHIPPING
MCA COMPLIANT:	YES
MAIN ENGINES:	2X CATERPILLAR 3512B 2250 HP
FUEL:	16100 G (60939 L)
WATER:	2600 G (9841 L)
CRUISING SPEED	17.5 KNOTS
MAX SPEED	18.7 KNOTS
STATEROOMS:	5
CREW CABINS:	5
LOCATION:	GULFPORT, MISSISSIPPI, UNITED STATES
ASKING:	29,800,000 USD

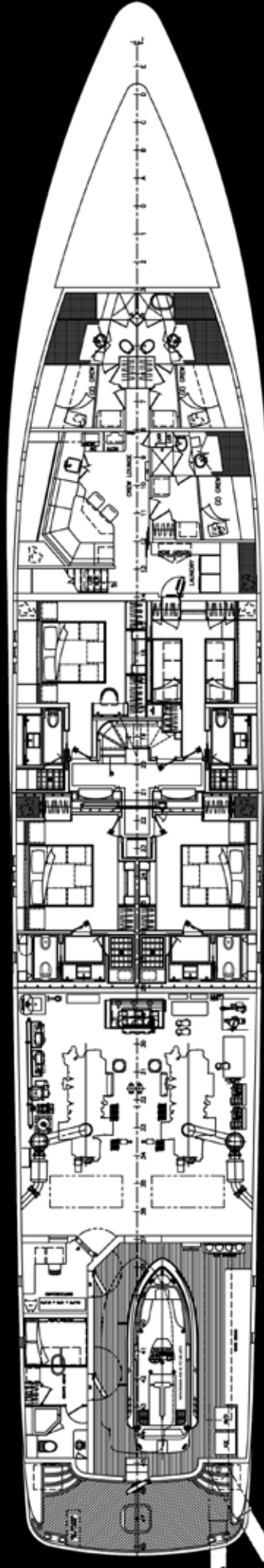
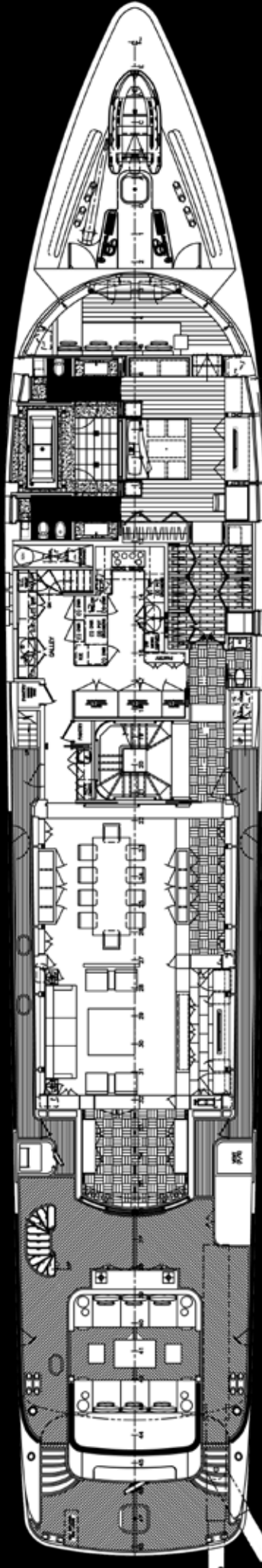
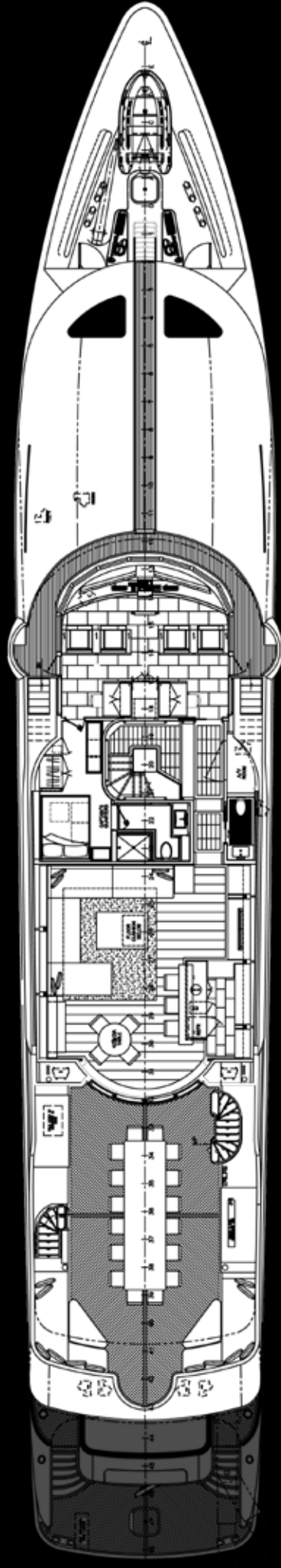
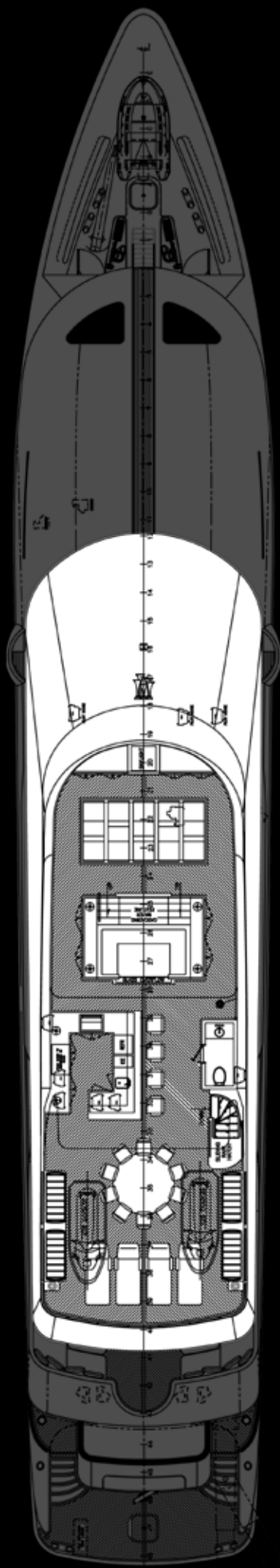

MAIN SALON



DINING SALON



MASTER STATEROOM



Accommodations and layout

EUPHORIA is designed for an Owner's party of ten with five staterooms for Owner and guests and a large Skylounge and Flybridge with hot tub, settee and head. The full-beam master stateroom is located forward on the main deck with large viewing panoramic windows. The four guest staterooms are centrally located below the main deck. The yacht is designed for a crew of ten with a captain's cabin (double) aft of the pilothouse and three double crew staterooms forward and an engineer's cabin (double with single bunk above) aft. The yacht has a tender garage suitable for a diesel Sport Jet tender (21.3 feet overall). The yacht has a large swim platform.

Capacities

Fuel Capacity	Approximately 16,100 US gallons.
Fresh Water Capacity	Approximately 2,600 US gallons.
Gray Water Capacity	Approximately 200 gallons sump collections; 1,400 gallons in a holding tank.
Sewage Capacity	Approximately 300 gallons
Clean Lube Oil Capacity	Approximately 170 gallons
Dirty Oil Capacity	Approximately 280 gallons
Clean Gear Oil Capacity	Approximately 55 gallons
Hydraulic oil storage	Approximately 110 gallons
<u>SPEED:</u>	
Maximum Speed (trial load)	18.7 Knots @ Full power (trial load)
Cruise Speed (trial load)	17.5 Knots - approximately 85% rated (continuous) HP
<u>RANGE:</u>	
Long range	10 Knots; 3000 nautical miles with 10% total capacity fuel remaining on board.

Mechanical Equipment

Engines	Two Caterpillar 3512 B "E" Rated SCAC 2250 HP at 1925 RPM
Gears	Two Reintjes; 3.047:1 gears
Generators	Two 130 Northern Lights sW @ 1800 RPM
Bow Thruster	150 hp hydraulic
Propeller Shafts	Aquatech 22 HS, Aquamet 22, Temet 25, Hydromet 680 - 5" dia.
Propellers	Two 5 blade Nibral approximately 56" dia.
Air Conditioning and Heating	Marine Air System chilled water system; Approximately 50 tons of A.C.
Fresh-air Makeup	Approximately 900 cfm
Main Engine and Main Generator Starting	24VDC isolated ground battery
Shore Connection	Two shore cords One 200A and One 100A at the Transom. One 125KVA ATLAS, or equal voltage/frequency converter transformer and galvanic isolators.
Ship's Service Alarms	24VDC isolated ground battery.
Emergency Lighting System	24VDC isolated ground battery.

Other Machinery

Watermakers	Two 2,400 GPD FCI or equal
Stabilizers	Gulf Med Marine (Quantum) - Mod QC 1500 two fins 3.0 sq. m. - "Zero Speed"
Bow Thruster	Quantum 150 hp hydraulic
Bilge/Ballast/Pump/Fire	Two Grundfos CRT-16-30 centrifugal Jabsco diaphragm
Emergency fire pump	Yanmar model L70V-80-60FP emergency fire/bilge pump
Oily Bilge Pump	Boss 2TY/107
Sewage System	Headhunter
Steering System	EMI or equal

Communication System

Satcoms:	Seatel 4006 V-Sat Thrane & Thrane Fleet 500 Nera Fleet 55 Thrane & Thrane Iridium Furuno Felcom 15 Sat-C
Telephone System:	8 lines
GMDSS:	Furuno RC1815 GMDSS A3 Console
SSB:	Furuno FS1570
VHF Fixed:	2x Furuno FM8800x (Bridge) 2x Standard GZX-2360S (ECR & Crewmess)
VHF Handheld:	2x Icom IC-M34 2x MC Murdo R1 (GMDSS)
Hailer:	Furuno LH3000
Cellular Phone System:	2x Ericson W25 GSM
Ship's Computer:	2x Vei Seapc (Capt & Engineer) 1x Vei Mail Server 2x Sony Laptops (Crew)
Ship's Printer:	Brother MFC7820N (Printer/Fax) Brother H14040CN (Color Laser)
Navtex:	Furuno NX700

Navigation

Radar:	Furuno	96nm
Radar:	FR2137SBB S-Band	Range
	Furuno FAR2127BB	96nm
	X-Band	Range
Autopilot:	C-Plath Navipilot 4000	
Gyrocompass:	C-Plath Navigat-X Mkii	
Compass:	Ritchie	
Depth Sounders:	Furuno FCV12001 + RD30 B&G Hydra 2000	
AIS:	Furuno FA-150	
GPS:	2x Northstar 6000I	
Electronic Chart:	Transas 3000 On Vei Sea PC	
Plotter:	Maxsea On Captain's PCNav	

Nav Displays	5x Vei 20" Seapc LCD Displays Vei SSIR LCD Touch Screen Monitor Control
Wind & Speed Indicator(s):	B&G Hydra 2000
Security Cameras:	Palladium SIMC-8-A CCTV Based Controller 6x Pelco CCTV Cameras
Ship's Monitoring:	Palladium Simon Ship's Monitoring System.

Entertainment Systems

Creston Central Control With Touchpad Wall Controls and Wireless Remote Controls in All Guest Locations, Controlling: All AV Applications, Air Conditioning Temp and Lighting

TV's:

(2) Ronco 32" Multisystem	Captain Cabin, Crew Mess
(3) Ronco 40" Multisystem	Upper Guest Cabin, Main Salon, Master Cabin
(2) Ronco 28" Multisystem	Guest Port Aft & Guest Stb Aft
(1) Ronco 50" Multisystem	Skylounge
(2) Sharp 30"	Guest Stb Fwd, Guest Port Fwd
(1) Sharp 20"	Galley

DVD's:

(5) Nad L53 Multisystem	Captain Cabin, Upper Guest Cabin, Skylounge, Guest Prt Aft, Guest Stb Aft, Sundeck and Crew Mess
(3) Acram DV78 Multisystem	Skylounge, Main Salon, Master Cabin
(2) Sony Kaleidescape System	Guest Stb Fwd, Guest Port Fwd Optional

Laundry Equipment

	<u>Quantity</u>	<u>Mft. & Model</u>
Main Laundry Washers	3	Miele PW6065
Main Laundry Dryers	3	Miele PT7136
Pressing Equipment	2	Rowenta Iron & Steamer

Galley Equipment

	<u>Quantity</u>	<u>Manufacturer</u>
Dishwasher	2	Miele G7859
Garbage Disposal	2	Kitchenaid KCDS100T
Icemaker	1	Kitchenaid KUIS18NNT
Microwave Oven	1	Kitchenaid KBMS1454SSS
Cook tops-4 burner	2	Miele KM5656
Ovens	2	Miele H4780
Refrigerator/Freezer	1	Delfield SSDRL
Refrigerator	1	Delfield MRR1S
Salamander & Hood	1	ESB36
Trash Compactor	1	Kitchenaid KUC503FTSS
Wine Cooler	1	U-Line 2175WC
Refrigerator Drawers	1	Subzero 700BR

Deck Equipment

Anchor Windlass System:	2x Miur VWC 1000
Anchors:	2x 594lb Pool Type
Anchor Chain & Rode Length & Size	2x 400ft 19mm Stud Link
Deck Capstans	2x Miur MVC 4000 (Aft Deck)
Main Tender Davits	1x Nautical Structures 4000 lb Overhead Beam Crane (Garage)
Add'l Cranes / Davits	1x Nautical Structures 2500lb MCA Rescue Tender Crane on Flybridge 1x Nautical Structures 1500 lb Foredeck Jetski Crane
Accommodation Ladders	2x Marquipt Sea Stairs
Stern Boarding Gangway	1x Marquipt Hydraulic Stern Paserelle

Master Stateroom

Full beam two-level master suite on main deck with forward panoramic viewing windows.

Guest Staterooms

Four (4) guest staterooms located below main deck.

Skylounge

Panoramic Sky Lounge and Flybridge with Hot Tub

Sundeck

50" LCD on a Drop Down Mount from the Overhead

Remarks

Delivery 16 months after placing order for interior

Disclaimer

Specifications are provided for informational purposes only. Data was obtained from sources believed reliable but is not guaranteed by owner or brokers. Buyer assumes responsibility to verify all speeds, capacities, consumptions and other measurements contained herein and otherwise provided and agrees to instruct his agents to confirm such details prior to purchase. Vessels subject to prior sale, price and inventory changes and withdrawal from market without notice.



LUXURY • CUSTOM • YACHTS

Trinity Yachts, LLC • 13085 Seaway Rd., Gulfport, MS 39503-4607 • Tel.: (228) 276-1000 • FAX: (228) 276-1001
Felix S. Sabates, Jr. (704) 905-4640 fs@felixsabates.com • John Dane, III (228) 276-1030 or (504) 723-8064 jdane3@TrinityYachts.com
William S. Smith, III (228) 276-1054 or (504) 723-8089 wssmith3@TrinityYachts.com

www.TrinityYachts.com